



### Ganging Artwork

When sending several images, you can “gang” your artwork. Setting up your artwork correctly saves us time and can save you money.

Artwork should have 1/2” between each image—see examples below of correct setup and “bad” setup.

For large orders the ideal document size is 17” wide x 23” long for unmounted dies and 14” wide x 23” long for MOUNTED dies.

### Correct Setup

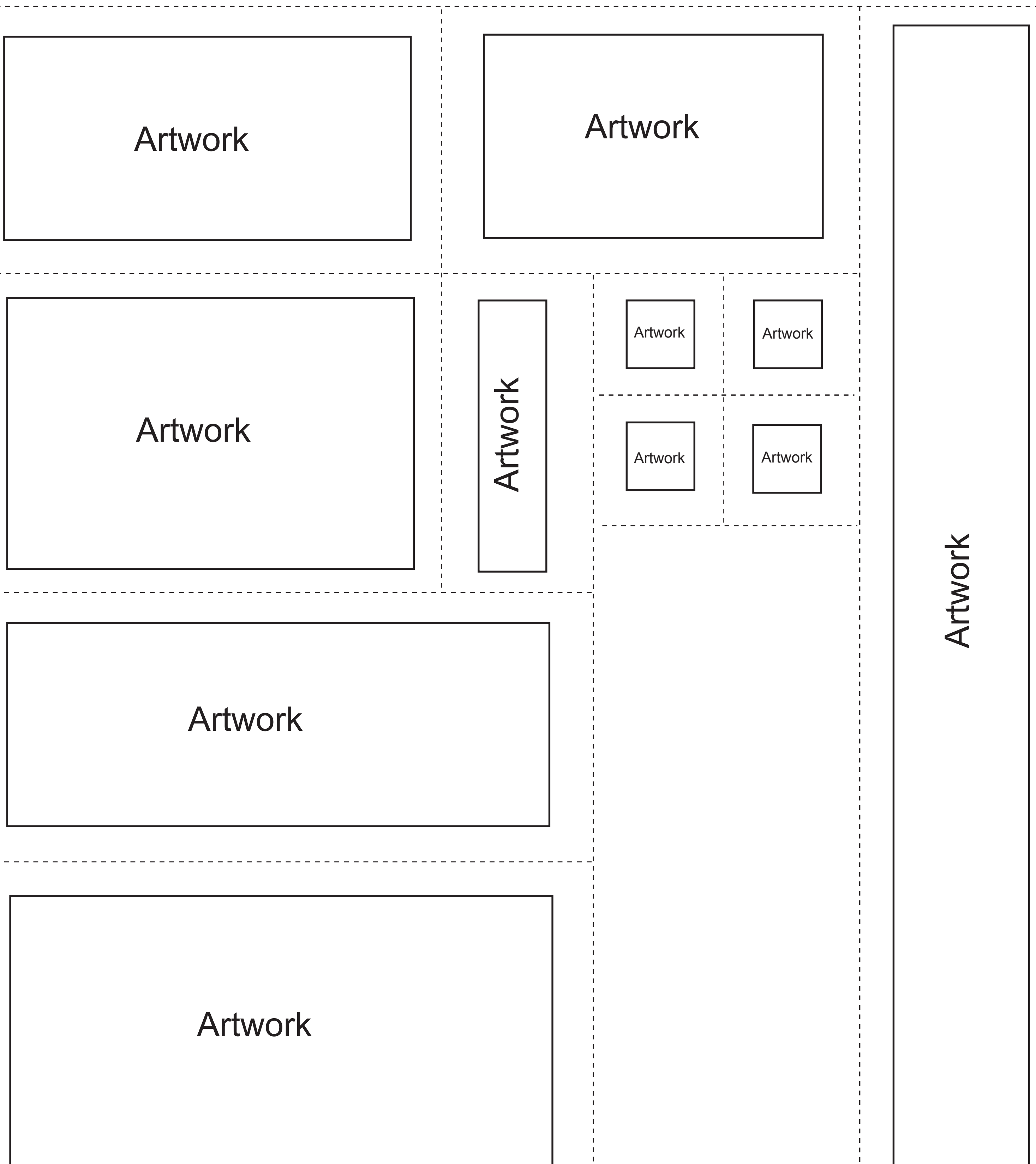
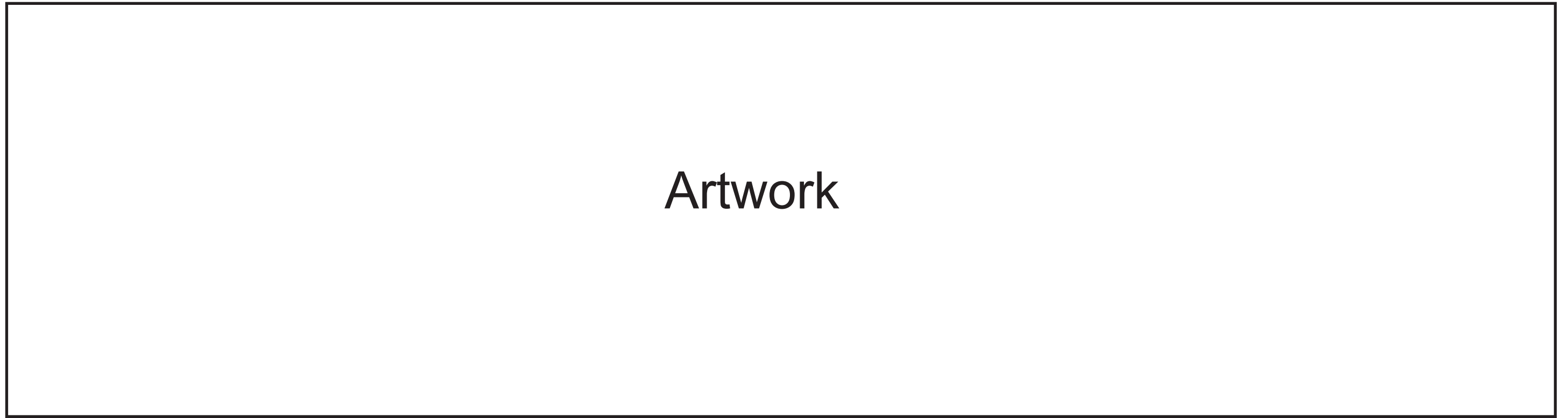



### Ganging Artwork

When sending several images, you can “gang” your artwork. Setting up your artwork correctly saves us time and can save you money.

Artwork should have 1/2” between each image—see examples below of correct setup and “bad” setup. For large orders the ideal document size is 17” wide x 23” long for unmounted dies and 14” wide x 23” long for MOUNTED dies.

### Bad Setup

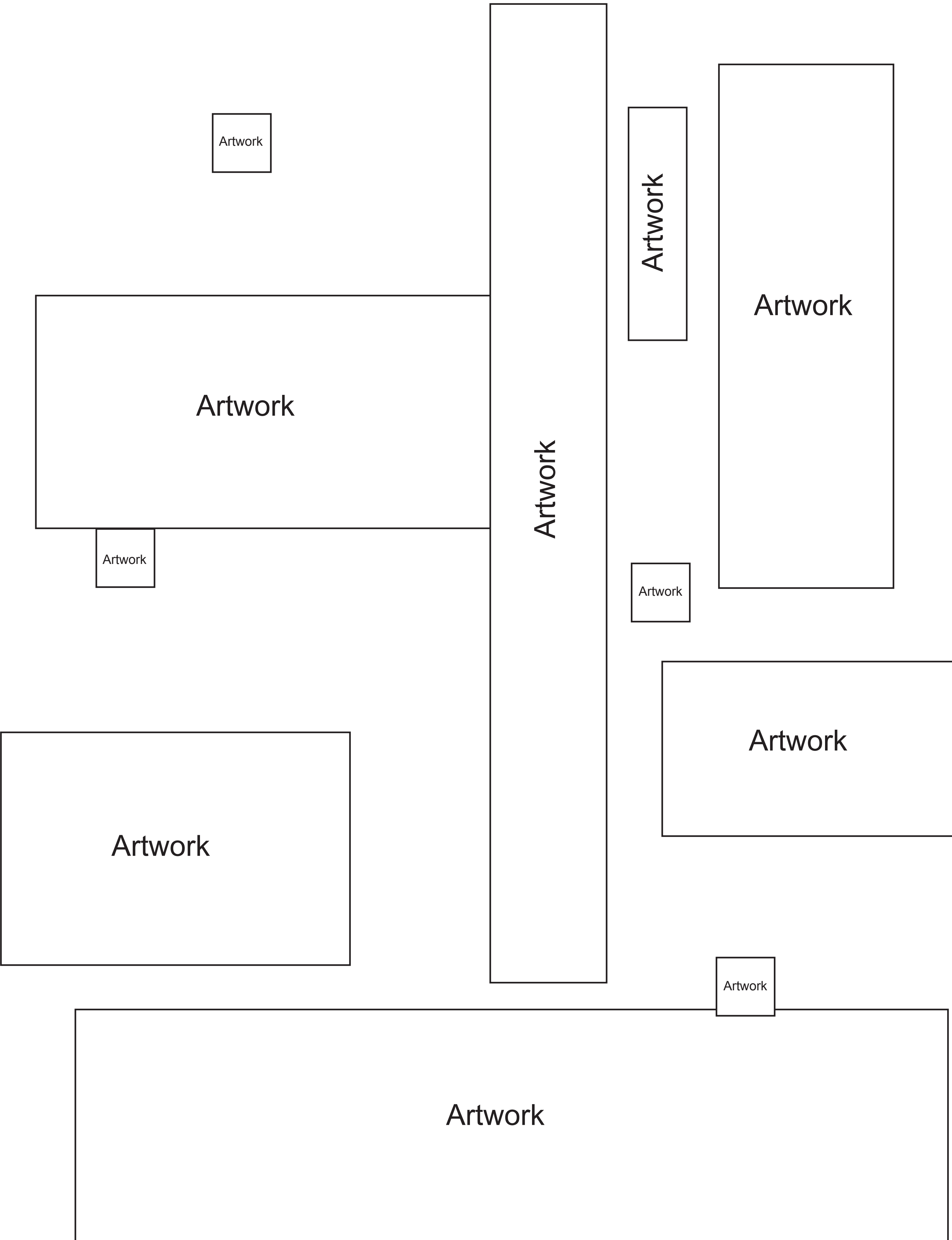

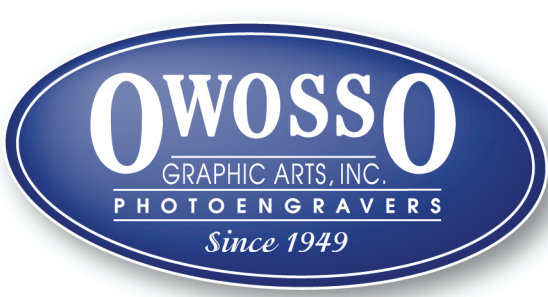

### Ganging Artwork

When sending several images, you can “gang” your artwork. Setting up your artwork correctly saves us time and can save you money. Artwork should have 1/2” between each image—see examples below of correct setup and “bad” setup. For large orders the ideal document size is 17” wide x 23” long for unmounted dies and 14” wide x 23” long for MOUNTED dies.

### Correct Setup

